

FEB 3 2015

8:30 AM

John Skelton
State of Oregon
State of Oregon Department of Transportation

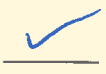

Responsible Person: Chris Chavez and Kristi Wilson

6. What other funding sources have you explored? Give details.
(Note: funds for this mini-grant must be expended by June 30, 2016)

@

ibm Date: 1 28 16

Approval or Denial (please circle one):

Division Chair or Supervisor

Date

Approval or Denial (please circle one)

Approval
M

2/23

2-

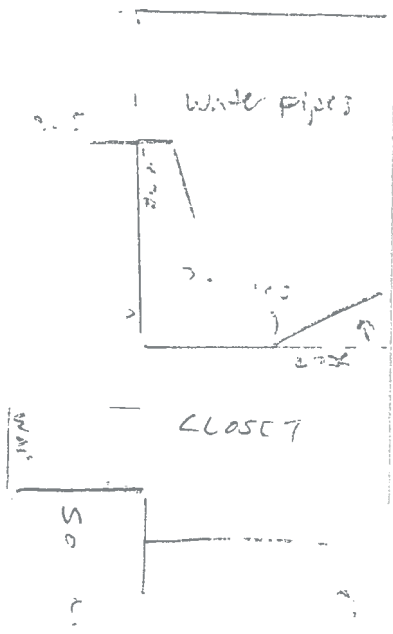

TOILET

WATER PIPES

CLOSET

SINK

WATER PIPES
TOILET
CLOSET
SINK

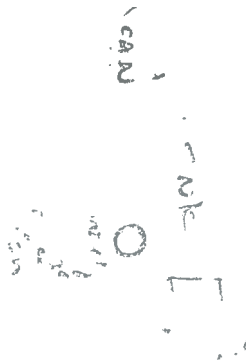

CUPBOARD

SINK

STOVE

ISSUES

1. Sink

2. Toilet

3. Cupboard

4. Stove

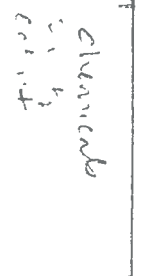
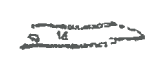

cleaner
sink
toilet

da
b
n

113-449



benches

S
er l (/" /'
ler /" /'
minu - (7'
20 " /') e
x 20 1/2) ii l c
6 " l o ks
ight
ope /" /" (
4 1 " /"
mb
SA

p n
orkbe
ng dra

113-600



113-602

s measuring
").

113-419



no sketch

114-031



* Request to Raise 7/8 work bench areas for students
to achieve the correct seated height/posture for
sawing from 28" to 38"

